

NOTICE INVITING TENDER

The International Islamic University, Islamabad invites sealed tenders on item rates basis from well-reputed established contractors registered with PEC (C-6) or above for the following jobs: -

S. No.	Description	Tender cost (non-refundable)	Completion Period	Earnest Money (refundable)
1.	Construction of boundary wall around the newly constructed Female Hostel at H-10, IIUI.	Rs. 5,000 Tender cost, in the form of Pay Order or Bank Draft in favor of International Islamic University, Islamabad	02-Months	2% of the bid cost in the form of Pay Order or Bank Draft in favor of International Islamic University, Islamabad

02. The tenderers may access the Tender Documents containing detailed terms and conditions, specifications, etc., on the websites of IIU, PPRA and EPADS (<https://eprocure.gov.pk>). International Islamic University, Islamabad, will follow the PPRA rule of single-stage single-envelope procedure.

03. The bids shall be prepared in accordance with the instructions in the bidding documents. The Tenderers must submit their bids on the EPADS only on or before the bid opening date and time. Any information regarding the above job may kindly be acquired from the office of the undersigned.

04. The bid must submit on EPADS on or before **07.01.2026 at 11:00 a.m.** will be opened by the Tender opening committee on the same day at 11:30 a.m. in the office of the undersigned in the presence of bidders / their representative (s) who may like to attend the bid opening. The bidders are required to submit the hard copies (along with original CDR) of their bids along with a copy of valid PEC registration and Income Tax Certificate, otherwise, their bids will be treated as cancelled.

05. The tenders shall remain valid for Three (03) calendar months after the date of opening of the tender. The University reserves the right to accept or reject any tender without assigning any reason as per the PPRA Rule.

(Muhammad Tazhar Qureshi)
Deputy Director (Civil)
Directorate of Works (Civil),
International Islamic University, Islamabad
No.051-9019525/9019531

**TENDER DOCUMENTS
FOR**

Construction of boundary wall around the newly constructed Female Hostel at H-10 IIUI

M/S _____

Date: _____

**DIRECTORATE OF WORKS (CIVIL)
INTERNATIONAL ISLAMIC UNIVERSITY ISLAMABAD**

DIRECTORATE OF WORKS
INTERNATIONAL ISLAMIC UNIVERSITY ISLAMABAD

TERMS & CONDITIONS

1. SCOPE OF TENDER:	The International Islamic University, Islamabad (hereinafter called the Employer) wishes to receive the tenders Construction of boundary wall around the newly constructed Female Hostel at H-10 IIUI . Bill of quantities on item rate basis is attached herewith. The rates will include all labour, material, scaffolding, tools and plant and all types of taxes as in terms & conditions of the tender documents. Tenderers must quote for the complete scope of work. Any tender covering partial scope of work will be rejected as non-responsive.
2. SUFFICIENCY OF TENDER:	Each tenderer shall satisfy himself before tendering as to the correctness and sufficiency of his tender and of the rates and the prices entered in the Price Schedule (Bill of Quantities), which rates and prices shall expect in so far as it is otherwise expressly provided in the contract, cover all his obligations under the contract and all matters and things necessary for the proper completion of the Works. The tenderer is advised to obtain for himself at his own cost and responsibility all information that may be necessary for preparing the tender and entering into a contract for execution of the works. The rates may be quoted after visiting the site and thoroughly understanding nature and type of the job.
3. TENDER SECURITY:	Each tenderer shall furnish, as part of his tender, an amount equal to 2 % (Two percent) of the total cost as tender security in the shape of Bank draft or Pay order in favor of International Islamic University, Islamabad. Any tender not accompanied by acceptable tender security shall be rejected by the employer as non-responsive. The tender security may be forfeited: If a tenderer withdraws his tender during the period of tender validity. In case of successful tenderer fails to sign the contract agreement after award of work. If a tenderer does not accept the correctness of his tender price. The tender security of the bidder shall be release after retained an amount of retention money over/equal to the bid security
4. VALIDITY OF TENDERS:	The tenders shall remain valid for the period of 03 calendar months after the date of tender opening.
5. COMPLETION PERIOD:	The work has to be completed within 02 Months from the commencement date.
6. LAST DATE FOR SUBMISSION OF TENDER	The bids must submit through EPADS on or before <u>07.01.2025 at 11:00 a.m.</u> will be opened by the Tender opening committee on the same day at 11:30 a.m. in the office of the undersigned in the presence of bidders / their representative (s) who may like to attend the bid opening. The bidders are required to submit the hard copies (along with original CDR) of their bids along with a copy of valid PEC registration and Income Tax Certificate, otherwise, their bids will be treated as cancelled.

7.MAINTENANCE PERIOD/ REMEDYING DEFECTS:	The maintenance period shall be six calendar months after the date of completion. The employer may at any time prior to the expiry of this period, notify the contractor of any defects. The contractor shall remedy at no cost to the employer any defects due to contractor's material, method, plant or workmanship not in accordance with the contract. Failure to remedy any such defects or complete outstanding work within a reasonable time shall entitle the employer to carry out all necessary works at the contractor's cost.
8.DATE OF COMMENCEMENT	The date of start will be reckoned after 07 (Seven) days from issuance of Work Order/Acceptance Letter
9. LIQUIDATED DAMAGES (L.D) FOR LATE COMPLETION:	If the contractor fails to complete the works within the time of completion, the contractor's liability to the employer for such failure shall be to pay the amount at the rate of Rs. 3,000/- per day or part thereof, will be imposed up to maximum limit of 5% of the contract value. There after the work will be got executed at the risk & cost of the contractor.
10. PAYMENTS:	This is an item rate contract. The contractor may claim running payments of the item of work done after satisfactory completion of his work.
11. SECURITY DEPOSIT/ RETENTION MONEY:	Retention Money equal to 5 % of work done from each Running and/or Final payment will be deducted by the Employer. Retention shall be released by the employer to the contractor within 14 days after either expiry of the maintenance period and/or the remedying of notified defects and/or the completion of outstanding work(s), whichever is later.
12. STORES:	No Store, T & P etc. shall be issued by the Employer to the contractor.
13. ESCALATION:	No Escalation will be paid on any of the Material, Labor, POL etc.
14. SUBLETTING:	The contractor shall not sublet the whole of the work. However, if it deemed necessary to do so; the part of the work(s) will be allowed for sub-letting subject to the prior approval of the Engineer but the contractor shall be sole responsible for acts, defects, defaults, payments etc. against whole of the work(s).
15.EXTENSION IN COMPLETION PERIOD:	<p>The contractor shall notify the Engineer/Employer in writing as soon as he is aware of any circumstances which may delay or disrupt the works, or which may give rise to a claim for additional payment.</p> <p>To the extent that the contractor's failure to notify results to the Engineer being unable to keep all relevant records or not taking steps to minimize any delay, disruption, or cost, or the value of any variation, the contractor's entitlement to extension to the time for completion or additional payment shall be reduced/rejected.</p> <p>The contractor shall be entitled to an extension to the time for completion if he is or will be delayed by any of the Employer risks subject to the contractor's notification of intention without unreasonable delay.</p> <p>On receipt of an application from contractor, the Engineer/Employer shall consider all supporting details provided by the contractor and the Employer may extend the time period for completion as appropriate.</p>
16. EXTRA ITEMS:	This is an item rate contract and any increase or decrease in quantities shall not invalidate the contract and same rates shall remain binding upon the contractor, however total cost of the contract should not increase more than 15%. Extra items will only be allowed and/or to be executed after obtaining its formal written approval from the Director (P&P). The payment for extra items if any will be made on the current market rates. The % age of overheads & profit to be allowed in such

	cases shall be 25%. For calculating the variation the current rates of labour and material shall be used for prevailing market rates and no escalation on account of material or labour wages shall be allowed on such items.
17. DISPUTES:	In case of any dispute between the Employer and the Contractor, the dispute shall be settled as per provisions of Arbitration act 1940 (Act. No. X of 1940). The place of arbitration shall be Islamabad. The matter shall first be referred to President, IIUI. <i>The decision of the President, IIUI will be considered as Final and Binding on both the parties.</i>
18. SAMPLES:	Approval of samples of all the material as desired by the Engineer-in-charge shall be obtained before bringing such material at site.
19. EARLY WARNING:	The contractor shall notify the Engineer/Employer in writing as soon as he is aware of any circumstances which may delay or disrupt the Works, or which may give rise to a claim of additional cost. To the extent that the contractor's failure to notify results to the Engineer/Employer being unable to keep all relevant records or not taking steps to minimize any delay, disruption, cost or the value of any variation, the contractor's entitlement to extension in time for completion or additional payment shall be reduced or rejected at all.
20. CONTRACTOR'S OBLIGATION:	The contractor shall execute the whole and every part of the work in the most substantial and professional manner. Both as regards materials and otherwise in every respect in strict accordance with the specifications, design, drawings and as directed by the Engineer-in-charge in best professional manner. Acceptance of any part of work will not relieve him from his obligation to execute the work and perform his duty according to specifications, best professional and moral ethics as per contract. Before execution of any activity inform to employer in writing and got a written approval by the employer for execution of work, otherwise no payment made against the said item. Said approval attached with the bill. Material test report, sample etc, cost bear by the contractor.
21. QUANTITIES	Quantities given in the bill of quantities are estimated and provisional, and are given to provide common basis for bidding. The basis of the payment will be actual quantity of work executed and measure by the contractor and verified by the Engineer and valued at the rate and price entered in the priced Bill of quantities, where applicable, and otherwise at such rate and price as the Engineer may be fix as per contract.
22. VARIATION (ALTERATIONS, ADDITIONS AND OMISSIONS)	The Engineer shall make any variation of the form, quality or quantity of the work or any part thereof that may, in his opinion, be necessary and for that purpose, or if for any reason it shall, in his opinion, be appropriate, he shall have the authority to instruct the Contractor to do and the Contractor shall do any of the following: Increase or decrease the quantity of any work included in the contract. Omit any such work, item or quantity. Change the character or quality or kind of any such work. Change the levels, lines, position and dimensions of any part of the work. Execute additional work of any kind necessary for the completion of the work, or. Change any specified sequence or timing of construction of any part of the work.
23. GENERAL	The bidder must sign each page of the Tender Documents, before submission the bid. He may as well visit the site before submission of bid. Any addition, deletion or modification of any clause of terms &

	conditions or BOQ of (IIUI) by any bidder will not be acceptable and may lead to rejection of the bid.
24. TAXES	All taxes will be applicable as per prevailing govt. rules.
25. MATERIAL TEST.	Testing of required material is responsibility of the Contractor.

Name & Address of the Firm _____

Signature, Stamp & Date: _____

Contact No: _____

**INTERNATIONAL ISLAMIC UNIVERSITY,
ISLAMABAD
Directorate of Works (Civil)**

**BOQ. Construction of boundary wall around the newly constructed Female Hostel at H-10
IIUI**

S.NO	DESCRIPTION	UNIT	QTY	RATE	AMOUNT
1-	Removing of Existing fence with G-I Pipe/pols and re-fixing of fence in proper line & level existing mesh fence and razor wire at new place with repairing & clamps and tension wire if required as per attached drawing, and site requirement, including demolishing of existing pole foundation. Foundation (PCC1:2:4) will be paid separately. complete in all respects as directed by the Engineer In Charge	RFT	220		
2-	Excavation in all kind of soil, including back filling where required and its disposal with in boundary limits of the University or stacking properly at approved place, including sub grade dressing, compacting, etc, complete in all respects as directed by the Engineer In Charge.	CFT	2347		
3-	Providing & laying, leveling & curing cement concrete (1:4:8) as in under foundation, or where required including form work and its removal where required, and leveling & curing etc, complete in all respects as directed by the Engineer In charge.	CFT	194		
4-	Providing & laying, leveling & curing cement concrete PCC (1:2:4) as in Bend Beam, top Copping, in base bottom of Fence or where required including form work and its removal where required, and excluding the cost of steel leveling & curing etc, complete in all respects as directed by the Engineer In charge.	CFT	1322		
5-	Providing & making retaining wall in random, stone masonry face well-dressed laid in 1:6 cement sand mortar, masonry to be laid in courses true to line, level and plumb, protected and properly cured including scaffolding and providing raised pointing ½" thick in 1:2 CM, completed in all respect as per drawings and specifications and as directed by Engineer in-charge.	CFT	3315		

6-	P/f of G/I Pipe 1-1/2" dia IIL (M) up to 10' ft height from for mesh fence & doors top head, with enamel paint silver color where required, with 2 No's of hold fast MS Angle Iron 1-1/2"x1-1/2" x 9", fixed at bottom of pipe and embedded in Concrete, fixing hooks, sliding bolt and locking arrangement, complete in all respects as directed by engineer in charge.	RFT	570		
7-	Providing and fixing wire netting , iron galvanized 50x50 mm mesh 10 SWG, 07 'ft height fixed with welded hooks 1/4" dia bars 3 numbers in U shape on each pole and two staples, for fence and doors complete with locking arrangements @ 02 numbers doors (12'x7'),01(6'x7') including holding, bracing etc, GI staples welded hooks etc with frame. Complete in all respect as per drawings or as directed by the Engineer In Charge.,	SFT	2485		
8-	Providing & fixing of 8 SWG tension wires at top & bottom of fence for making it tight and to protect against unfastening, Complete in all respect as per drawings or as directed by the Engineer in Charge.	RFT	2300		
9-	Providing & fixing of Razor wire on the top of existing mesh fencing 18" Dia best quality on fence, including 02 hole in G.i pipe for crossing of tension wire complete in all respect as directed by the Engineer in Charge. (razor wire one role open maximum 25'Rft,	RFT	460		
10-	Providing and fixing of Green Cloth , 95% Blind complete in all respect as directed by the Engineer in Charge.	SFT	2800		
11-	Providing & fixing weep hole 4" dia UPVC pipe best quality complete in all respects as directed by the Engineer In Charge.	RFT	156		
			Total Amount Rs:		

Name & Address of the Firm _____

Signature, Stamp & Date: _____

Contact No _____

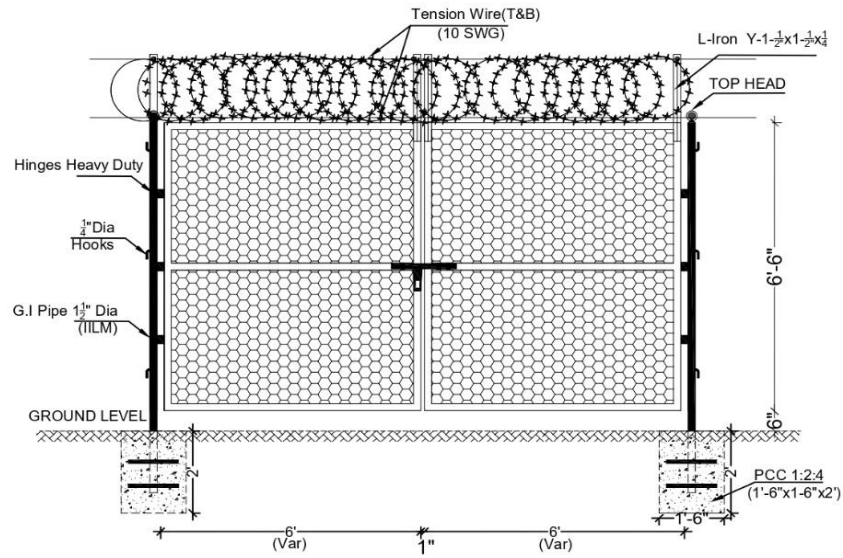

FENCE GATE

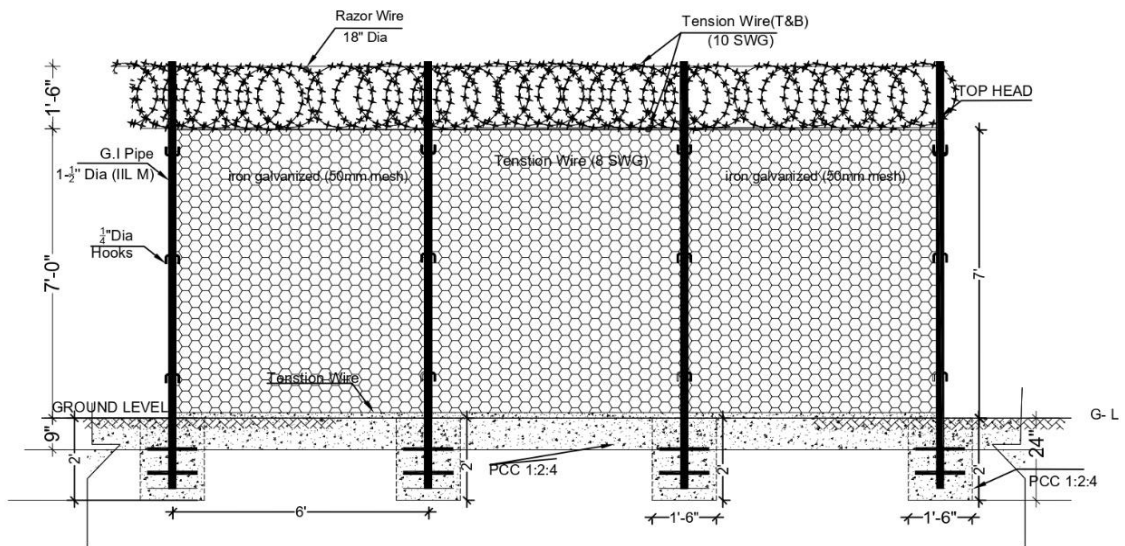

Elevation of Boundary Wall / Fence Wall

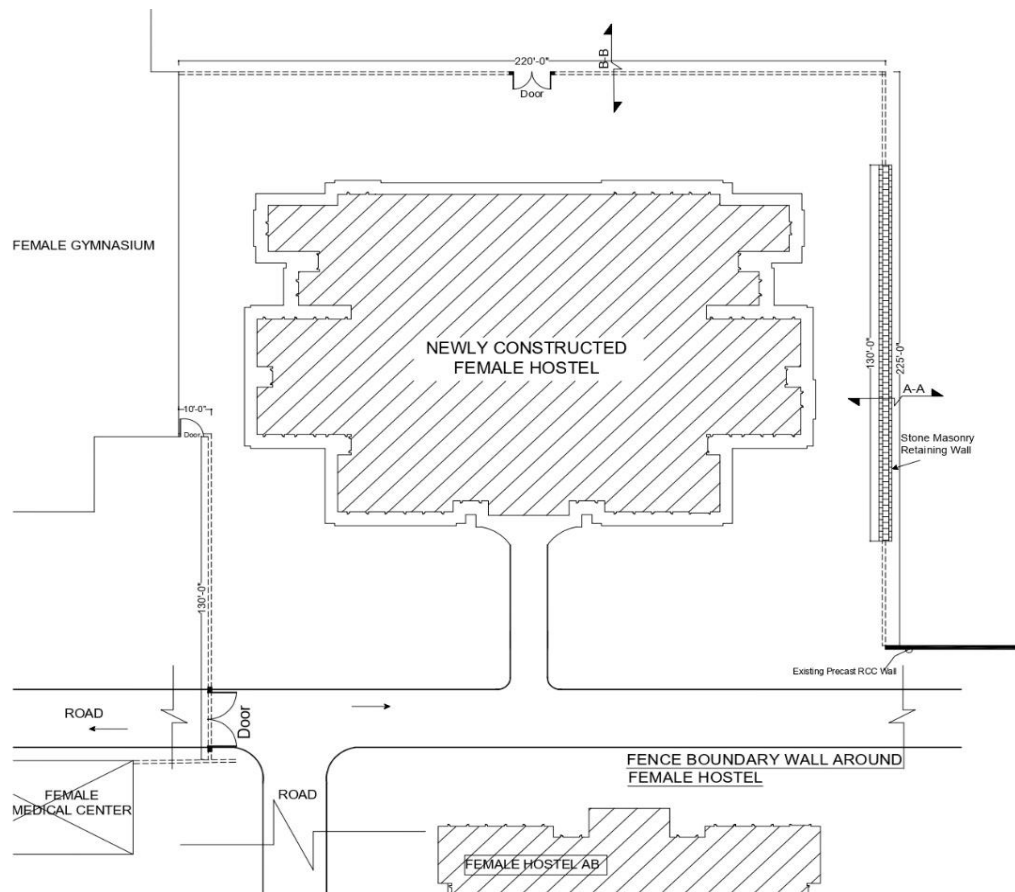

Fixing Of Mesh Fence Wall Around Female Hostel

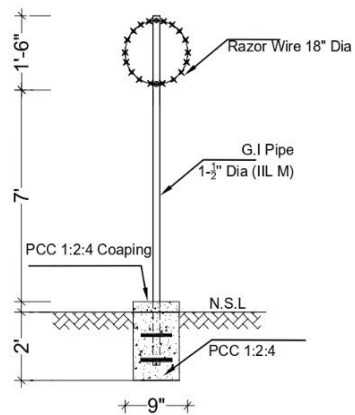

X- Section of Mesh Fence (B-B)